

15-17 Eastgate Street, Bury St. Edmunds, Suffolk, IP33 1XX
Tel: 01284 760770
bury@shiresestateagents.co.uk
www.shiresresidential.com

shires

Estate & Letting Agents



Pettits Drive, Bury St. Edmunds, Suffolk, IP32 6GT

Rent - £1,550 PCM Deposit - £1,788

Shires Residential are pleased to offer To Let this BRAND NEW terraced property located on the popular Marham Park development. In brief the accommodation comprises entrance hall, living room, kitchen/ dining room with integrated appliances, bedroom 1 with en-suite, two further bedrooms and a bathroom. There is parking to the front and an enclosed garden to the rear. Viewing highly recommended.

- BRAND NEW TERRACED HOUSE
- ENTRANCE HALL, CLOAKROOM
- KITCHEN/ DINING ROOM WITH INTEGRATED APPLIANCES
- TWO FURTHER BEDROOMS, BATHROOM
- COUNCIL TAX BAND C
- ALLOCATED PARKING
- LIVING ROOM WITH STAIRS TO FIRST FLOOR
- BEDROOM 1 WITH FITTED CUPBOARD AND EN-SUITE SHOWER ROOM
- UNFURNISHED, EPC 85, B, GAS FIRED HEATING
- MINIMUM TERM TENANCY OF TWELVE MONTHS



Council Tax Band: C - EPC Rating: B 85

GROUND FLOOR
36.3 sq.m. (391 sq.ft.) approx.

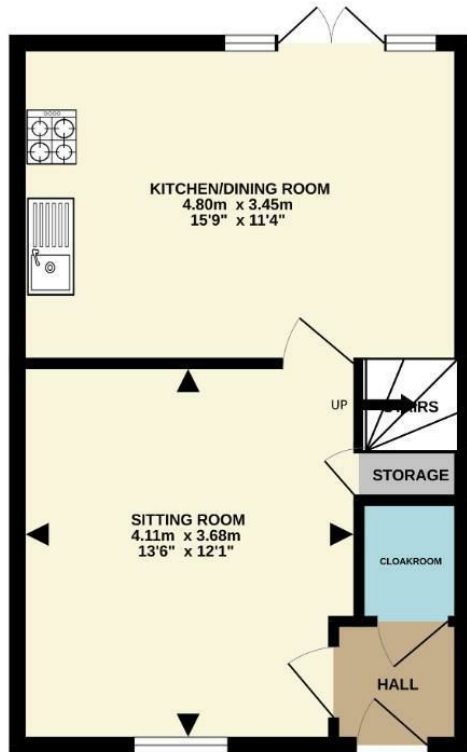

1ST FLOOR
36.9 sq.m. (397 sq.ft.) approx.

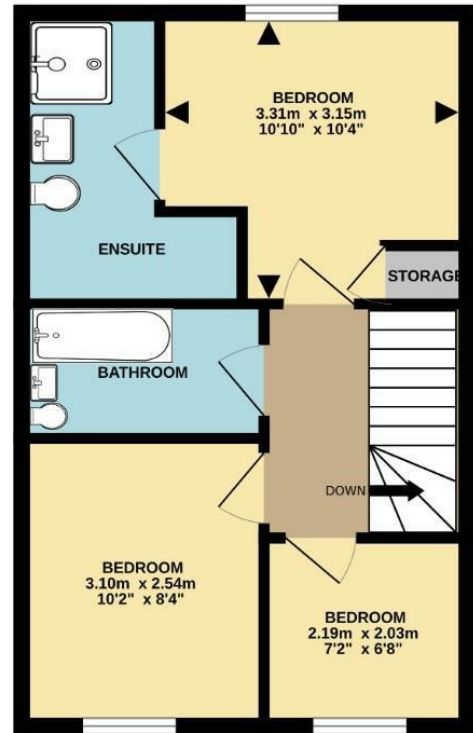

TOTAL FLOOR AREA: 73.2 sq.m. (788 sq.ft.) approx.

Whilst every attempt has been made to ensure the accuracy of the floorplan contained here, measurements of doors, windows, rooms and any other items are approximate and no responsibility is taken for any error, omission or mis-statement. This plan is for illustrative purposes only and should be used as such by any prospective purchaser. The services, systems and appliances shown have not been tested and no guarantee as to their operability or efficiency can be given.
Made with Metropix ©2025

